

**VALVOLE OLEODINAMICHE IN OTTONE SERTO**  
per tubi di rame e di plastica

**SERTO HYDRAULIC VALVE IN BRASS**  
for seamless copper and plastic tubes

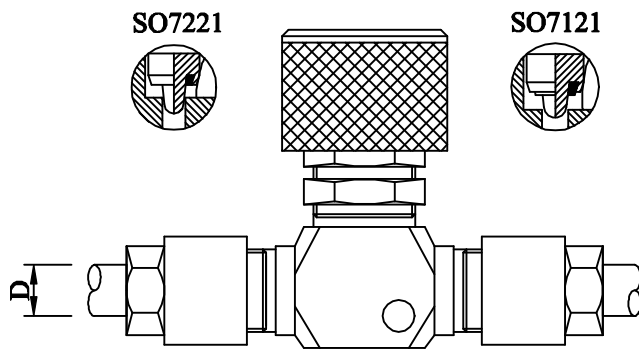

SO7121 = valvola di regolazione  
regulating valve (PE =50bar)  
SO7221 = valvola di regolazione fine  
fine regulating valve (PE =50bar).  
D = 6 - 8 - 10 - 12mm

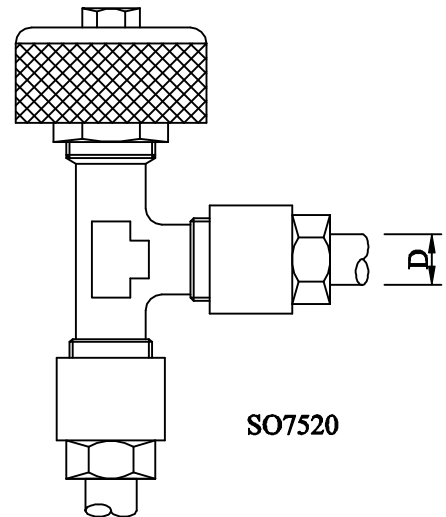

SO7520  
Elbow shut-off valve (PE =50bar).  
Valvola di arresto ad angolo (PE = 50bar).  
D = 6 - 8 - 10 - 12mm

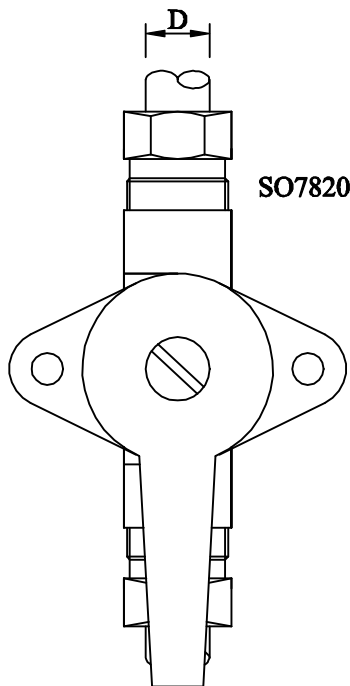

SO7820  
Total-flow cock (PE = 10bar).  
Valvola a flusso libero (PE =10bar).  
D = 6 - 8 - 10mm

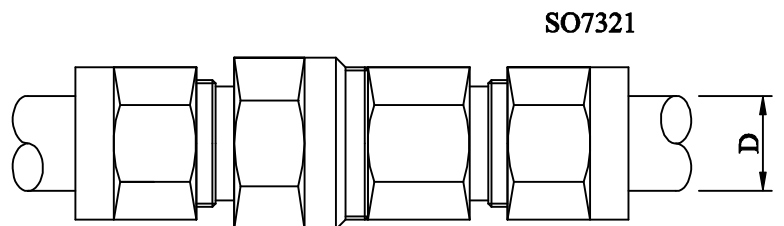

SO7321  
Taper seat non-return valve (PE =50bar).  
Valvola di ritengo a sede conica (PE =50 bar).  
D =6 - 8 - 10 - 12mm